

WASHER  
WRAPPED THREAD (WITH A SMALL DROP OF CA GLUE)  
2 1/4" DAVE BROWN "ELECTRIC WHEELS"

TRAILING EDGE 1/8" x 1/2" BALS  
1/4" MED BALS

1/8" MUSIC WIRE

WING CROSS SECTION

ALL MEMBERS 1/4" SQ MED BALS

3/16" BIRCH PLY

1/8" MEDIUM BALS

1/4" SQ HARD BALS

3/16" DOWELS

CG

1/2" x 1/2" TRI STOCK

CLOTH HINGES (3)

3/16" PLY LANDING GEAR MOUNT

3/16" DOWELS

1/2" BALS OR 1/4" x 2" PLY PYLON

SIDE DRAWN AS IF FLAT - BUILD BOTH SIDES FROM THIS

FIN POST

PYLON CROSS SECTION

1/4" DOWEL EMBEDDED IN PYLON AND FUSE (SEE CROSS SECTION A)

CONTROL NYRODS

.035" MICARTA (OR SIMILAR MATERIAL) CONTROL HORN (RIGHT SIDE OF RUDDER)

SCRAP BALS FILLER

1/64" PLY

MOTOR ARMING SWITCH  
Rx SWITCH

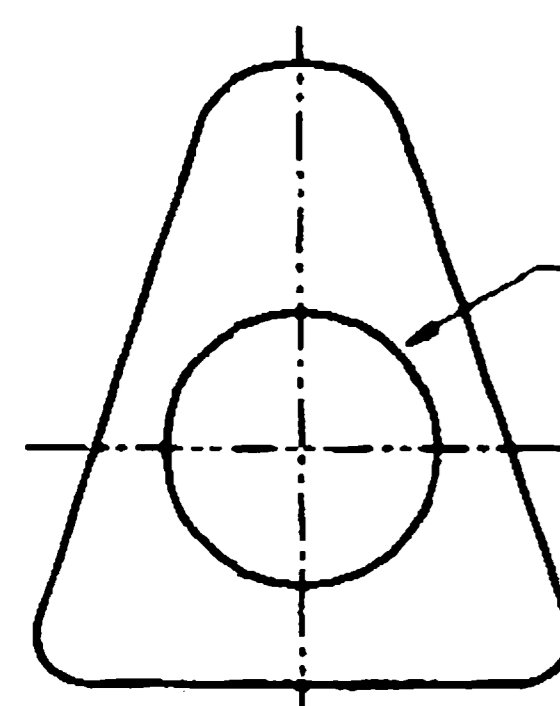

1 1/16" HOLE FOR MOTOR

AIR INTAKE

RADIO RECEIVER LOCATION

1/8" BALS FLUSH WITH RIGHT SIDE ONLY

RUDDER

1/8" DOWEL

3/16" PLWOOD FIREWALL

FIREWALL (LEFT SIDE)

RIGHT SIDE

1/64" PLY ON BOTTOM TO LANDING GEAR WIRE

ALL CROSS MEMBERS 1/4" SQ HARD BALS

BATTERY KEEPER

SIDE BY SIDE FUTABA S-133 SERVOS

ELEVATOR

BENT PIN

BOTTOM DIAGONALS STOP HERE

LONGERONS ARE SLIGHTLY BEVELED (DO NOT ROUND AT STAB. LOCATION)

800 mAh  
6 OR 7 CELL  
BATTERY PACK  
"3 OVER 4" STYLE

OPEN FOR AIR EXIT

INSTALL AFTER BATTERY

DIAGONAL CROSS-MEMBER ON BOTTOM 1/4" SQ HARD BALS

SECTION C  
SUPPORT FOR NYROD CONTROL LINKS (2 PLACES)  
CROSS-MEMBERS AND DIAGONALS ALL 1/8" x 1/4" MEDIUM BALS FROM HERE BACK

EXTRA CA AND SODA IN NOTCH, FULL LENGTH OF FUSELAGE

APPROX .012" CELLULOID COWL TEMPLATE (CUT OVERSIZE AND TRIM EXCESS)

SEE CROSS SECTION A

COWLING FIRE WALL

GEARBOX AND COWLING MOUNTING

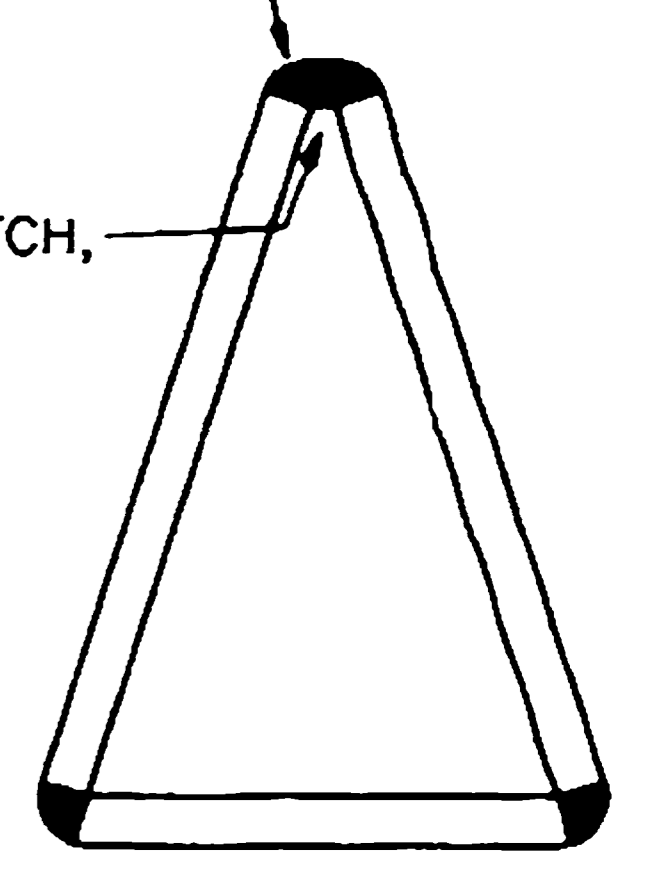

SECTION C

SIDE CROSS MEMBERS AND DIAGONALS

MOTOR MOUNTING PLATE

MOTOR AND GEARBOX MOUNTING

MASTER AIRSCREW MA3025K  
MOTOR, 2.5:1 GEARBOX, FOLDING PROP, AND SPINNER COMBO

TOP VIEW

BOTTOM VIEW

SCRAP BALS FILL

HOLE FOR FIN POST

OPEN AREA FOR AIR EXIT IN BOTTOM

SECTION C

NOTE: TOP LONGERONS RIDE TOGETHER SEE CROSS SECTIONS A AND C FOR CLARITY

BOTTOM CROSS MEMBERS AND DIAGONALS

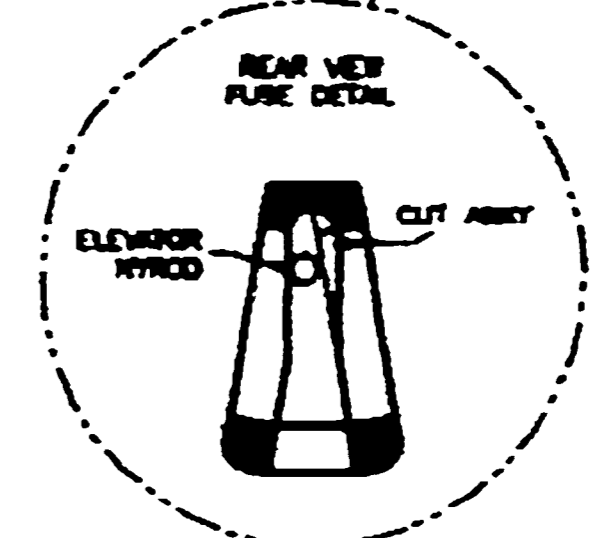

REAR VIEW FUSE DETAIL  
ELEVATOR NYROD  
CUT AWAY

1/8" HOLES FOR 1/4" OR 3/8" SHEET METAL SCREWS

FRONT VIEW ISOBAR (1/6 SCALE)

PYLON

1/4" DOWEL

1/4" HARD BALS GUSSETS

OPTIONAL 1" OR 2" DIHEDRAL SHOWN

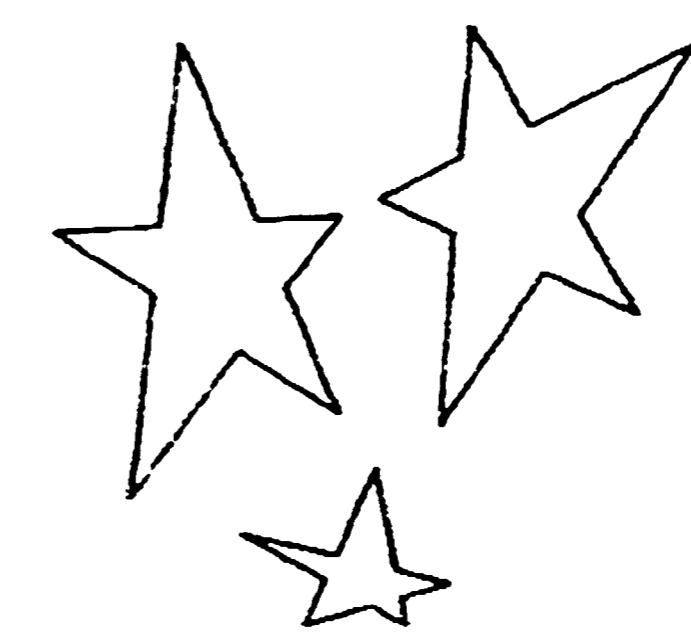

TYPICAL SKEWED STARS FOR DECORATION

MOTOR MOUNTING PLATE  
.025" TEMPERED ALUMINUM (7075 OR SIMILAR)

CROSS SECTION A

© RCM ALL COMMERCIAL RIGHTS RESERVED

**ISOBAR** Sheet 1 of 2

Designed By: Norm Weis Original Plans By: Jim Copen CAD Plans By: James Renger

PLAN NO. 178

ELEVATOR TRAVEL APPROX. 3/4" AT T.E.  
RUDDER TRAVEL APPROX. 3" AT T.E.

STABILIZER RIBS  
8 • 1/16" Balsa  
2 • 1/4" Balsa



WINGTIP CROSS SECTION

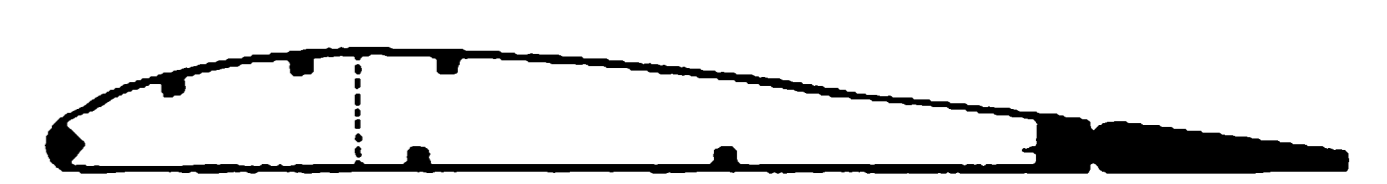

1 SHORT 1/4" Balsa RIB

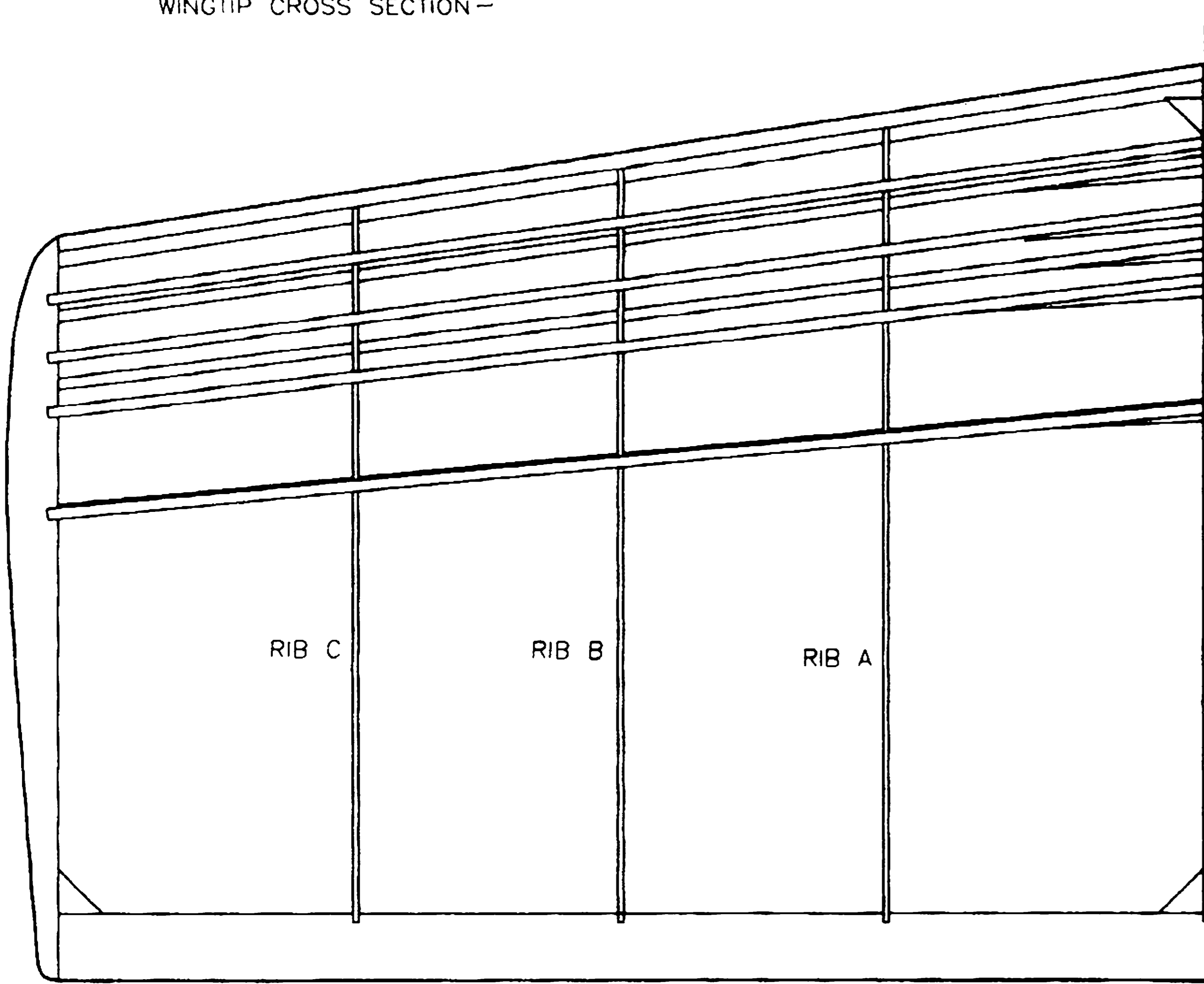

LEFT SIDE WING VIEW

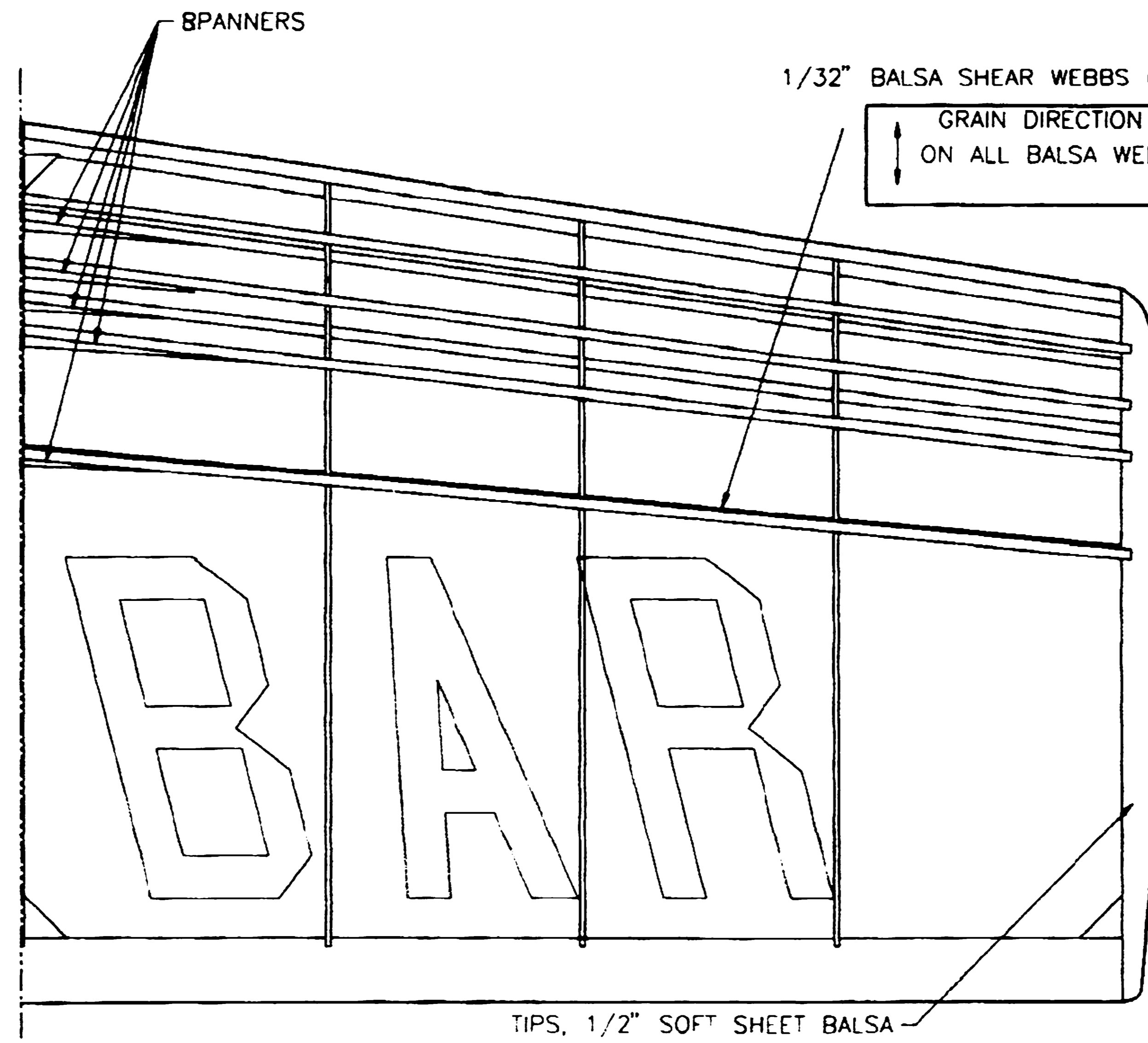

SEE TEXT FOR DIHEDRAL INFO

1/32" Balsa SHEAR WEBBS (FRONT ONLY)

GRAIN DIRECTION  
ON ALL Balsa WEBS

1/4" Balsa SHEET

3/16" SQ HARD Balsa LEADING EDGE

ALL SPARS 3/32" SQ HARD Balsa

CLOTH HINGES (6)

LIGHTNING HOLES (1/2" TO 7/8")

1/4" (TAPERED) SOFT Balsa ELEVATOR

1/4" x 5/16" (HIGH) MED-SOFT Balsa

CONTROL HORN (SLIGHTLY OFF CENTER)

TIPS, 1/2" SOFT SHEET Balsa

1/4" SQ HARD Balsa LEADING EDGE  
1/32" BASS SHEAR WEBBS (BOTH SIDES)

GRAIN DIRECTION  
ON ALL BASSWOOD WEBS

1/8" SQ SPRUCE SPAR (TOP AND BOTTOM)

1/8" SQ HARD Balsa SPARS

1/16" Balsa SHEAR WEBBS (FRONT ONLY)

GRAIN DIRECTION  
ON ALL Balsa WEBS

HOLE FOR RUDDER POST

1/4" "SHORT" CENTER RIB

1/4" "LONG" CENTER RIBS

3" WIDE CENTER COVERED WITH 1/64" PLY

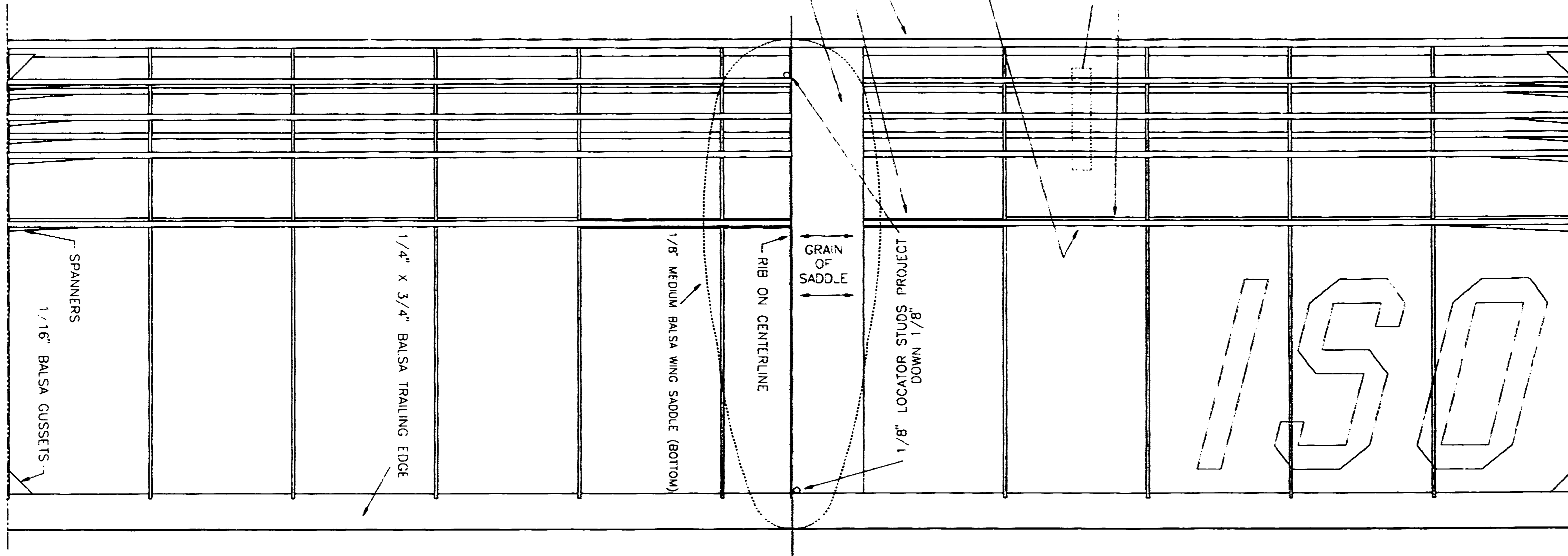

CENTER SECTION RIB x 13

RB A x 2

RB B x 2

RIB C x 2

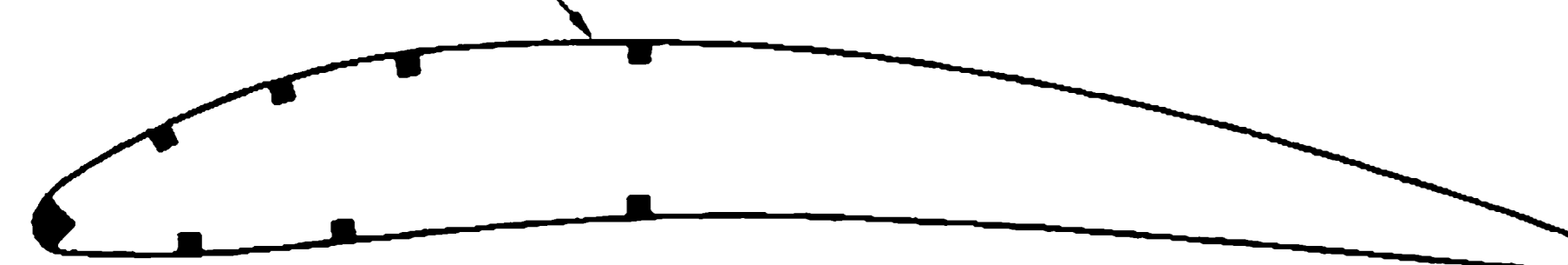

ALL (13) CENTER SECTION RIBS 1/16" HARD Balsa

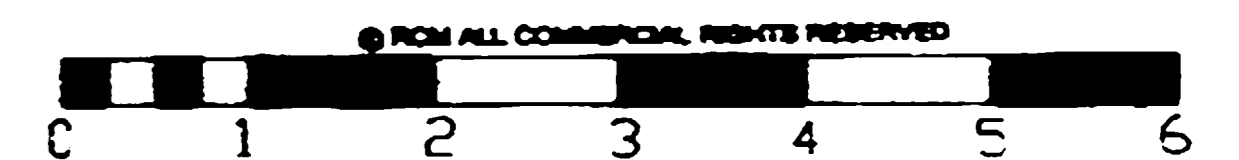
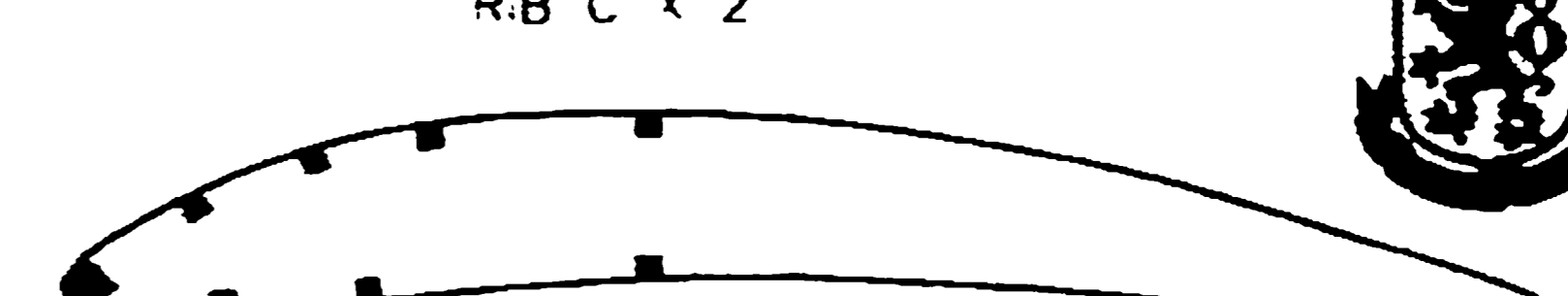
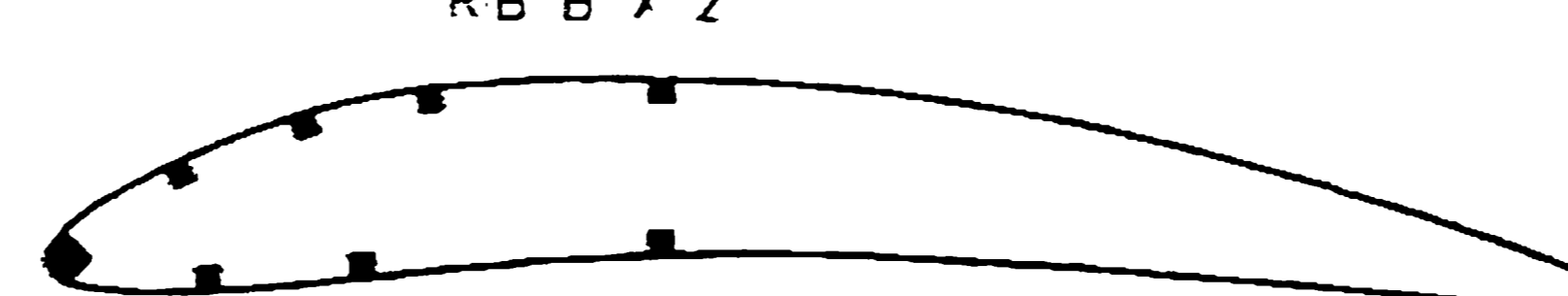
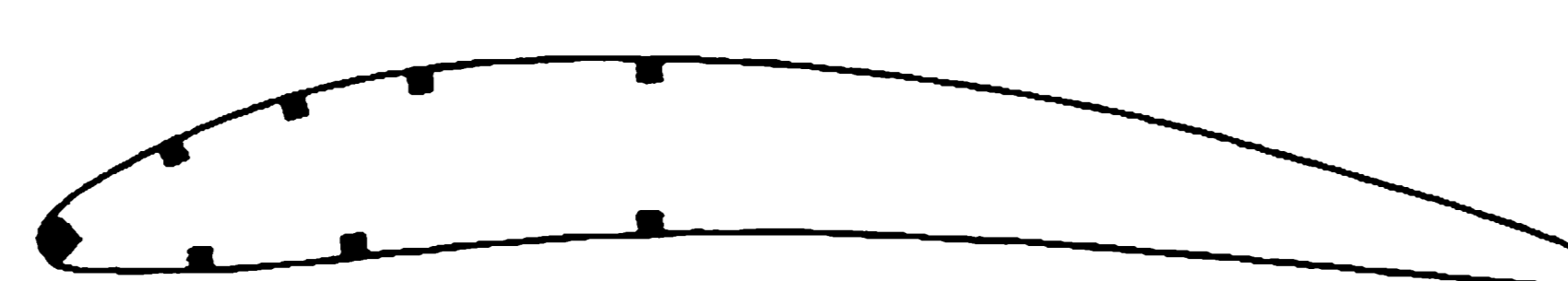

ISOBAR

Sheet 2 of 2

PLAN NO. 1176