

ALL RUDDER RIBS ARE 3/32" SHEET BALSAL, EXCEPT AS NOTED.



WING SPAN	85"
WING AREA	1030 sq"
OVERALL LENGTH	62"
STABILATOR SPAN	29"
STABILATOR AREA	174 sq"
REC. ENGINE SIZE (TWO)	40 CU. IN.
FINISHED DRY WEIGHT	16-17 LBS.

NOTE: STABILATOR AND RUDDER PUSHROD INSTALLATION SHOULD BE RIGID AND FREE OF "PLAY OR SLOP" IN THE LINKAGES.

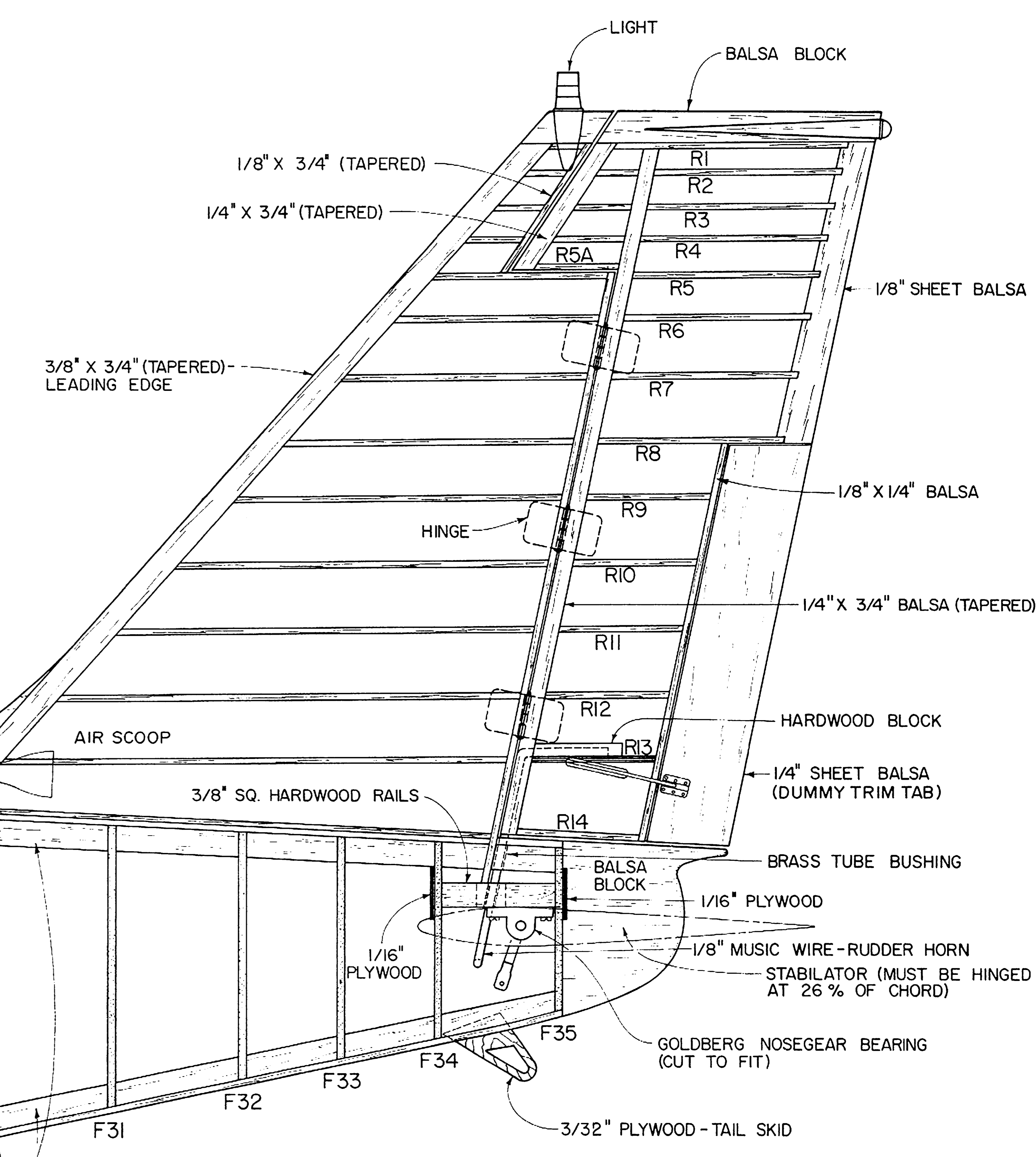
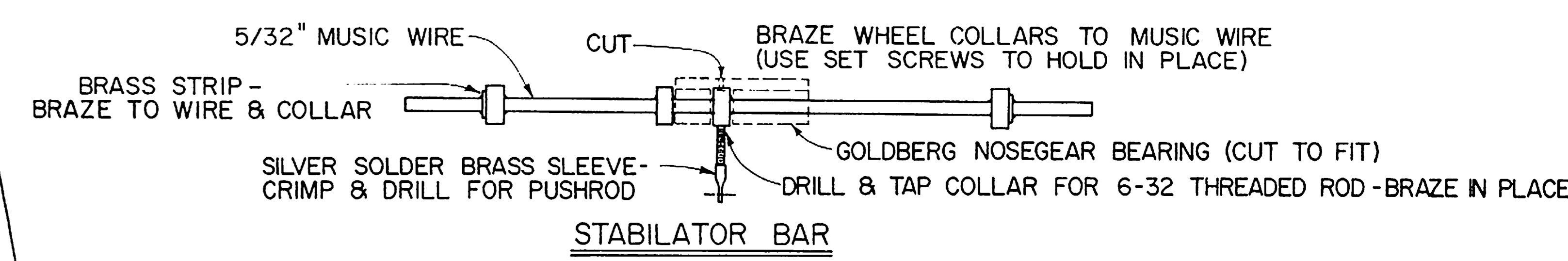
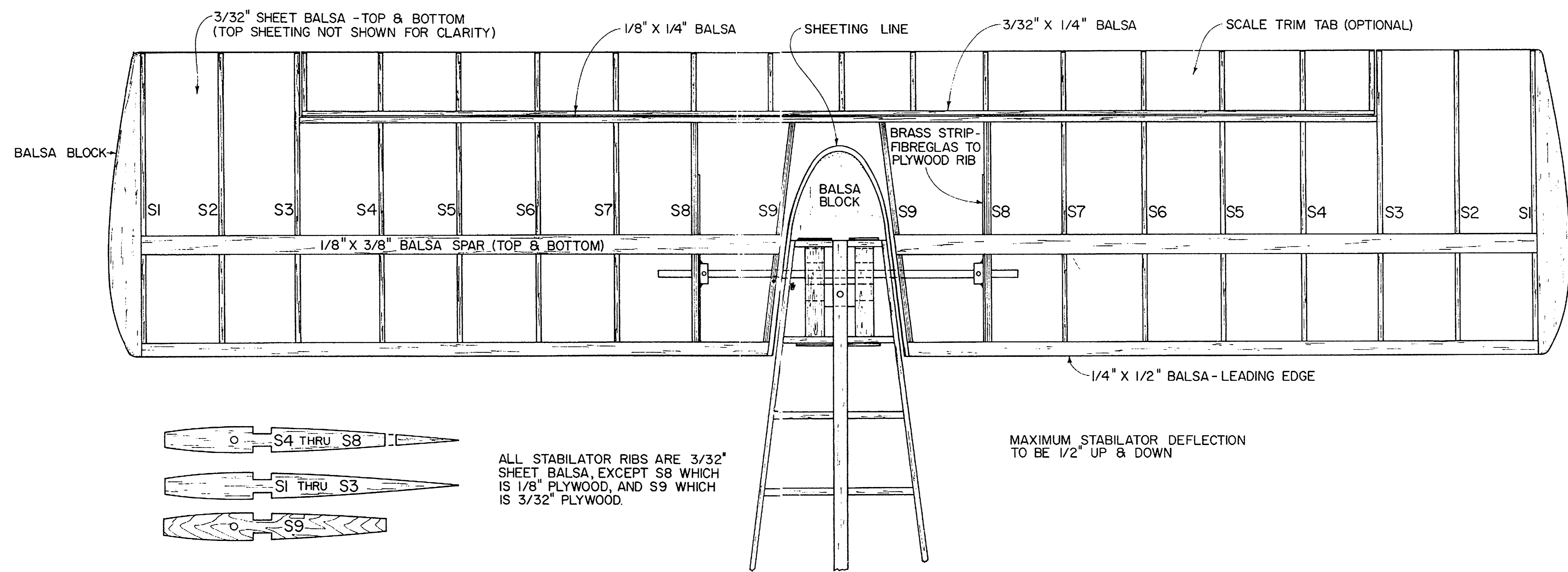
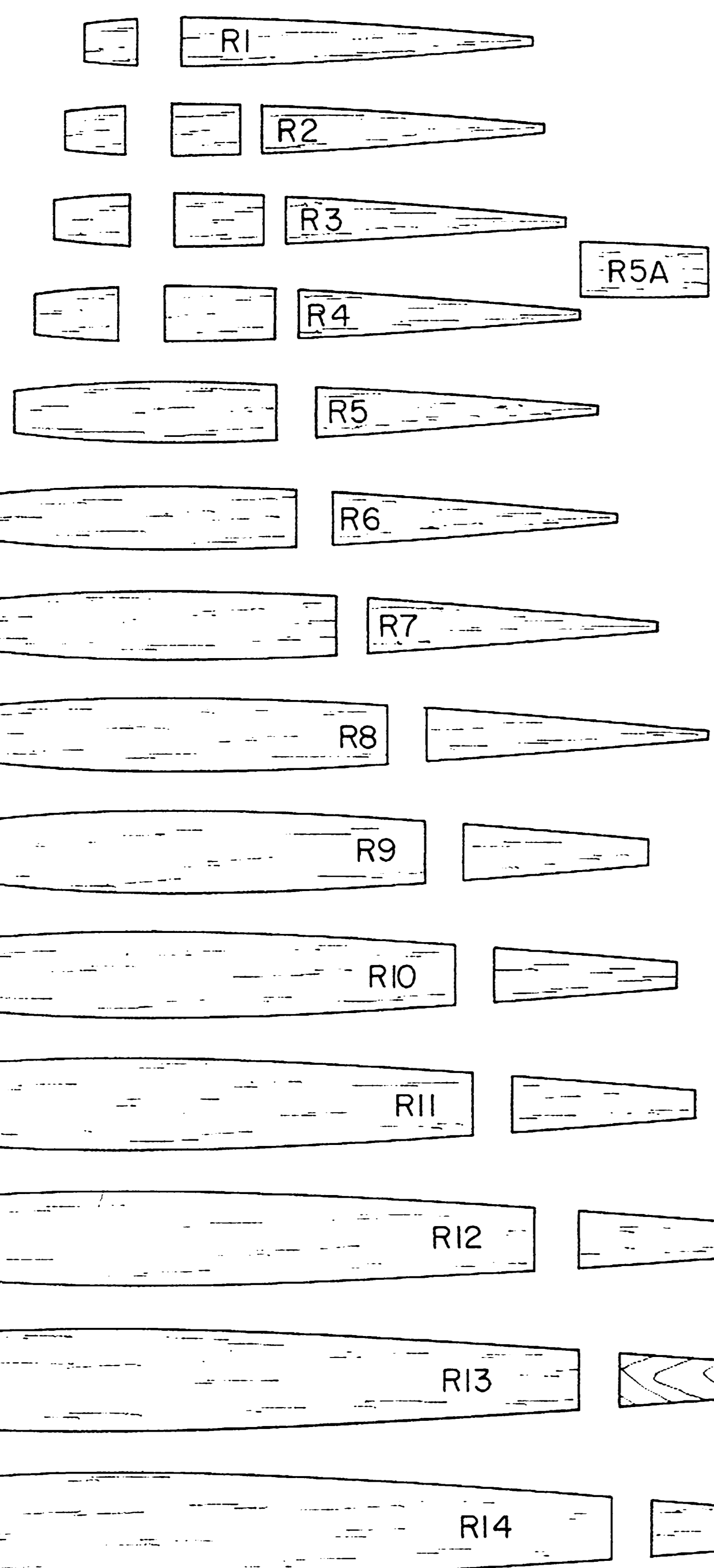

By H.E. SHEET 1 OF 3

DESIGNED & DRAWN BY JERRY BUGNI
INKED & ARRANGED BY Bob Wallace

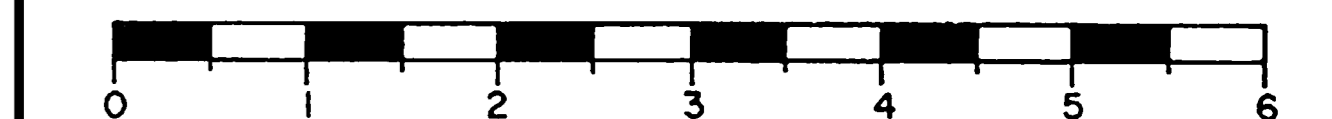

NACELLE CRUTCH POSITION LINES-FOR REFERENCE ONLY, DO NOT CUT OUT.

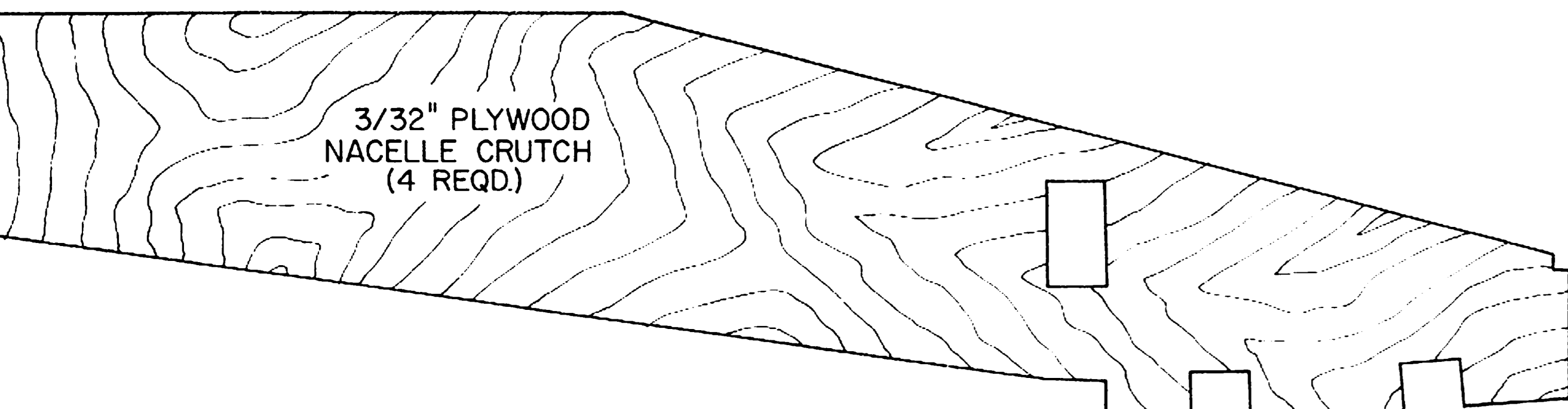
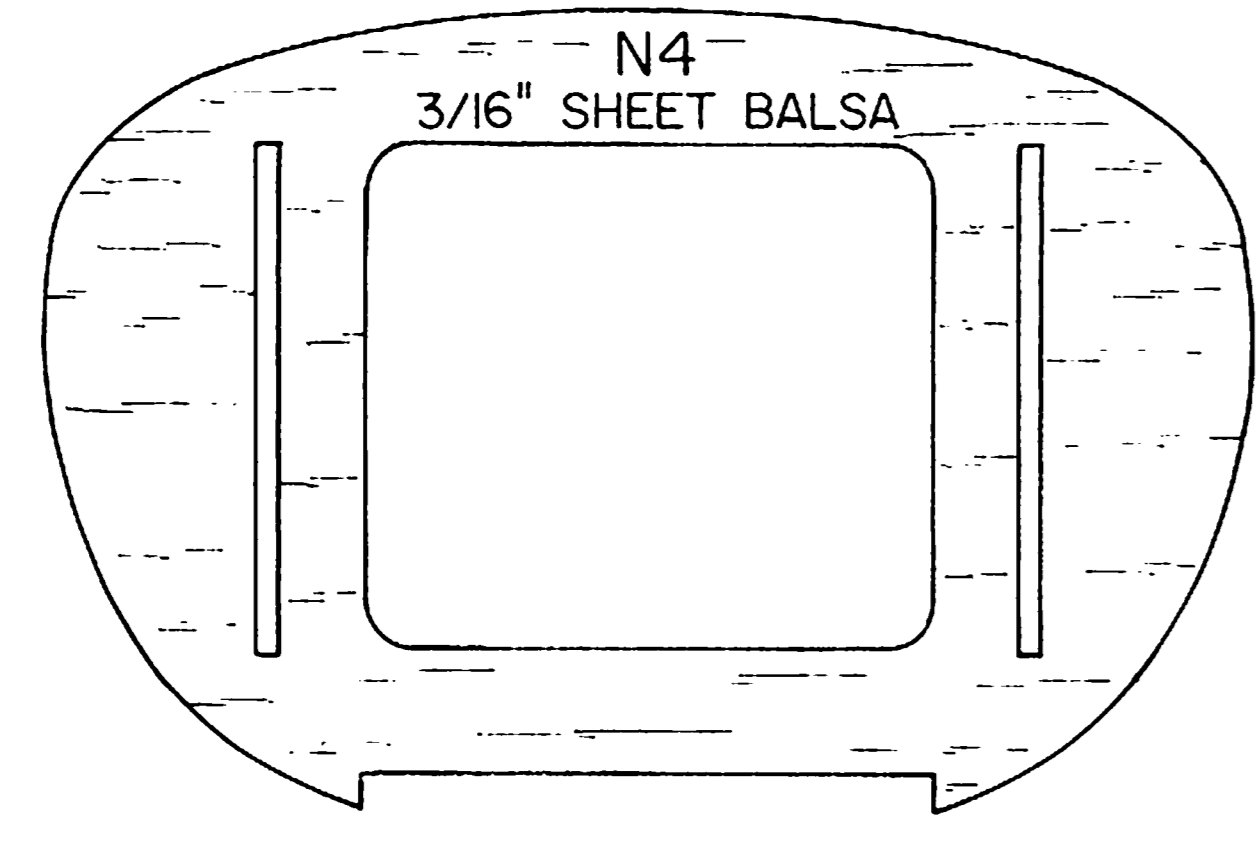
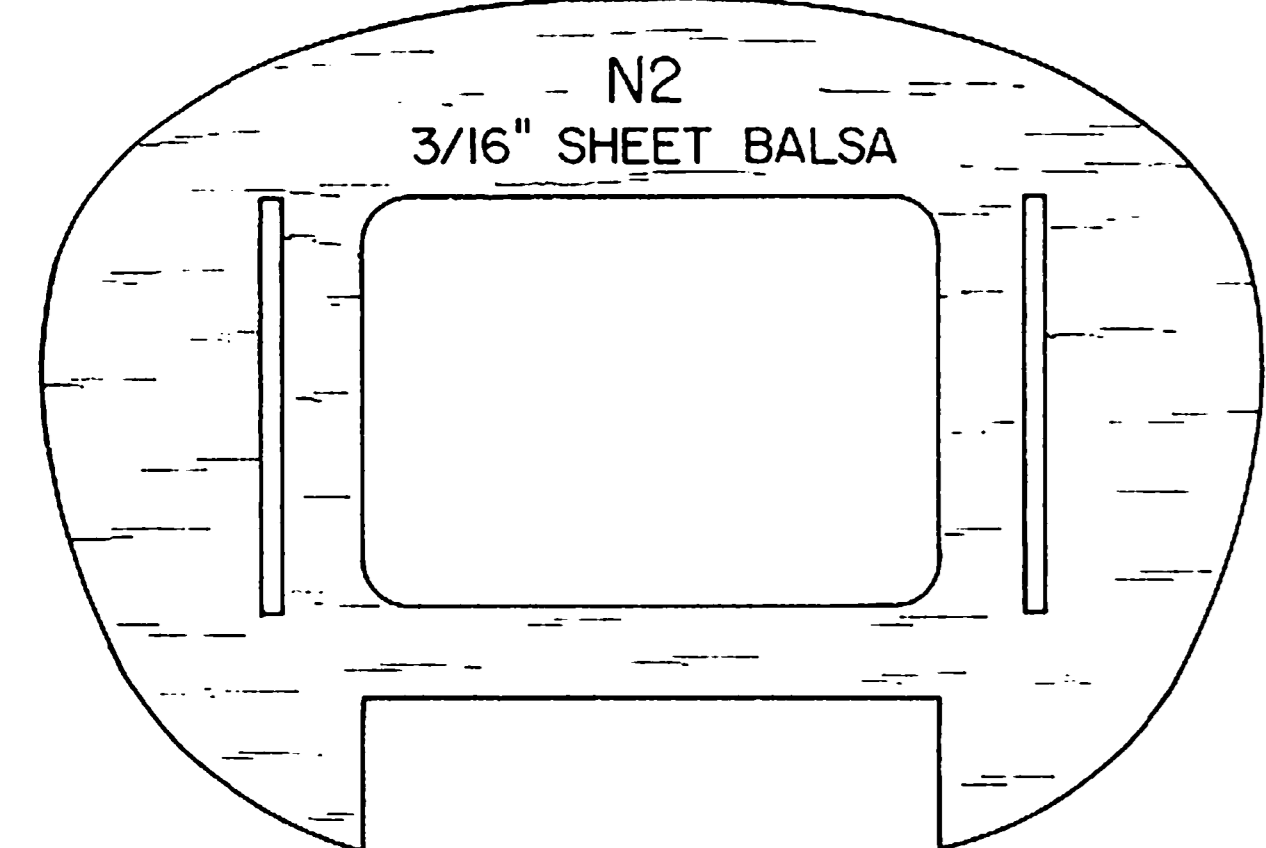
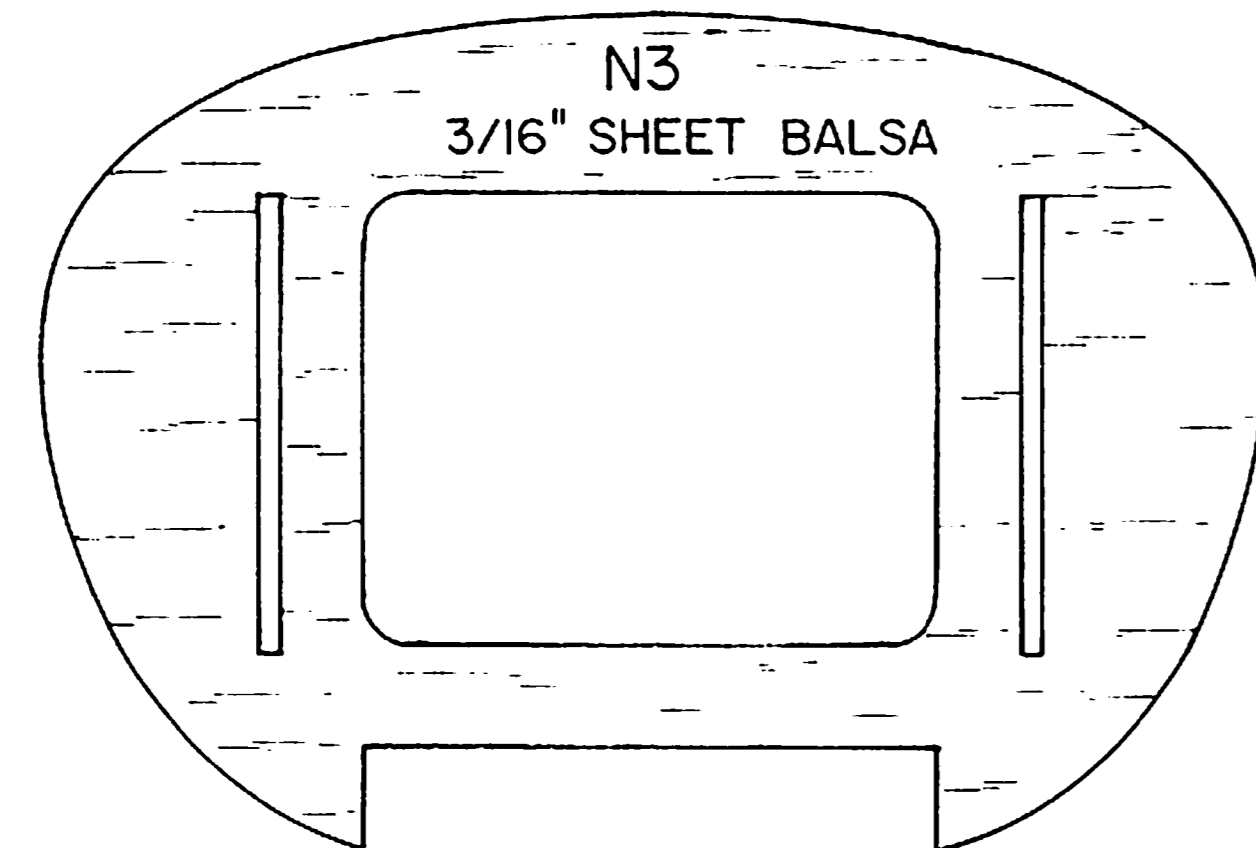
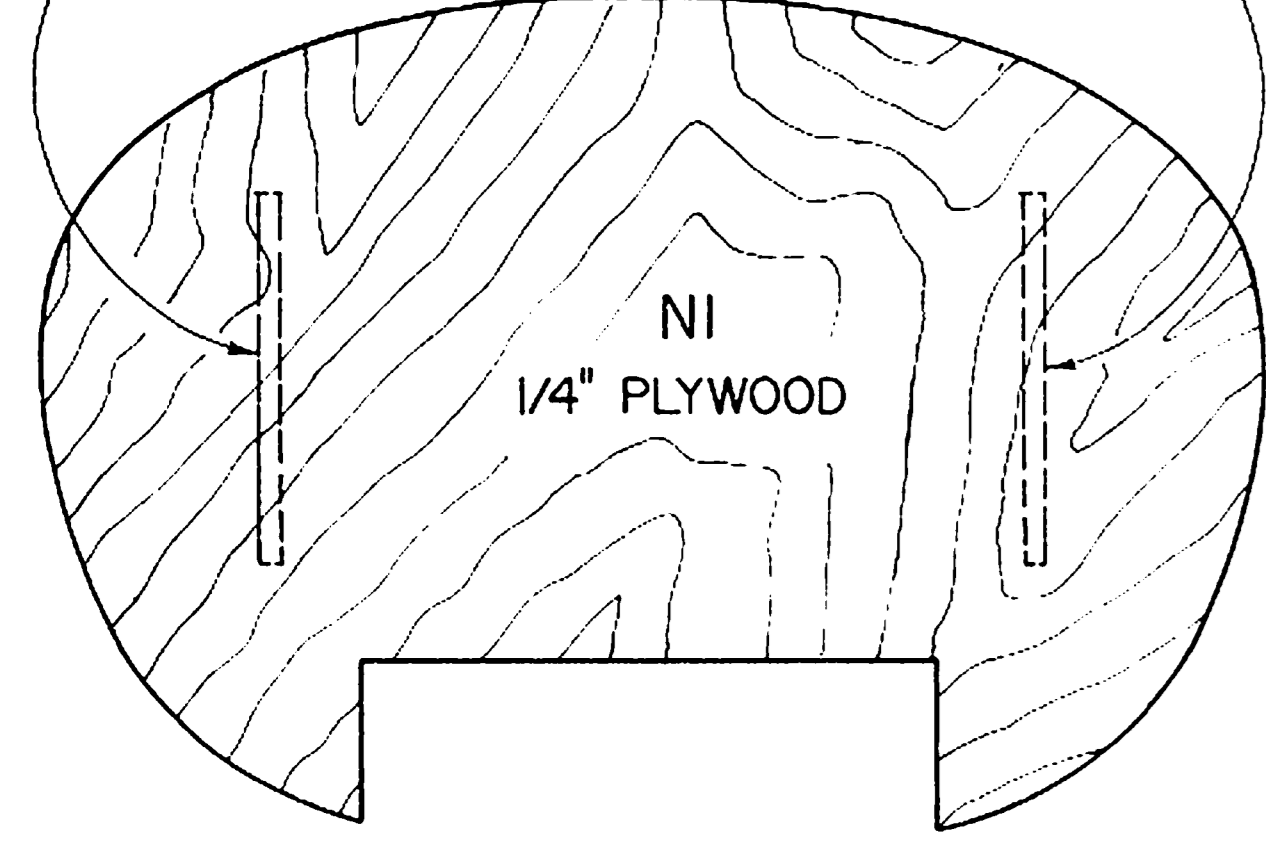

W1 ONLY-CUT OUT AS REQUIRED, TO ACCEPT SERVO



W1 THRU W4 (8 REQD.)

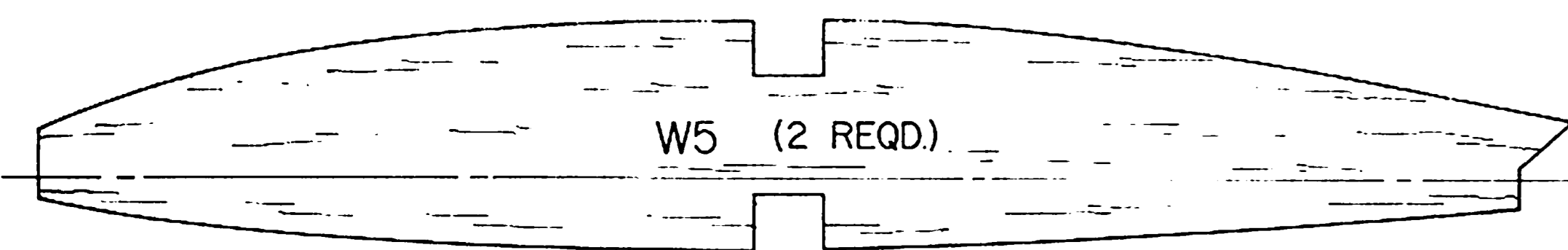

W5 (2 REQD.)

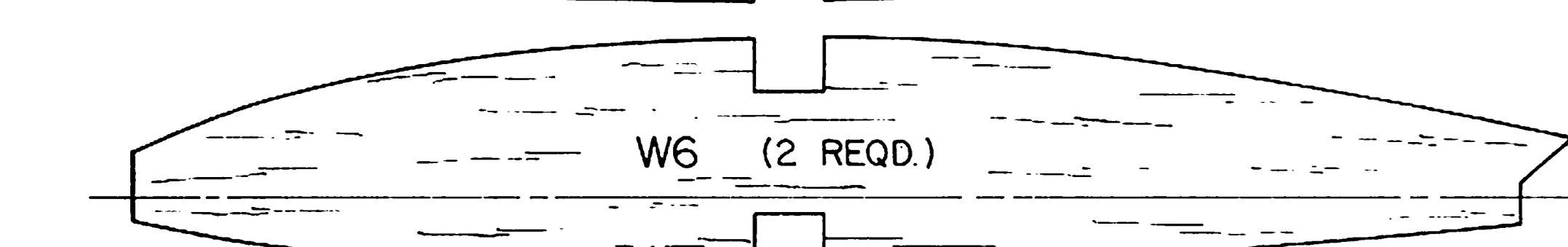

W6 (2 REQD.)

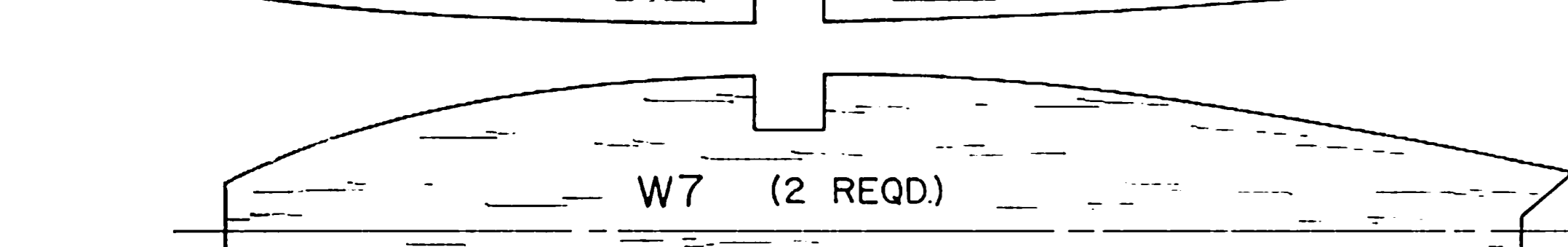

W7 (2 REQD.)

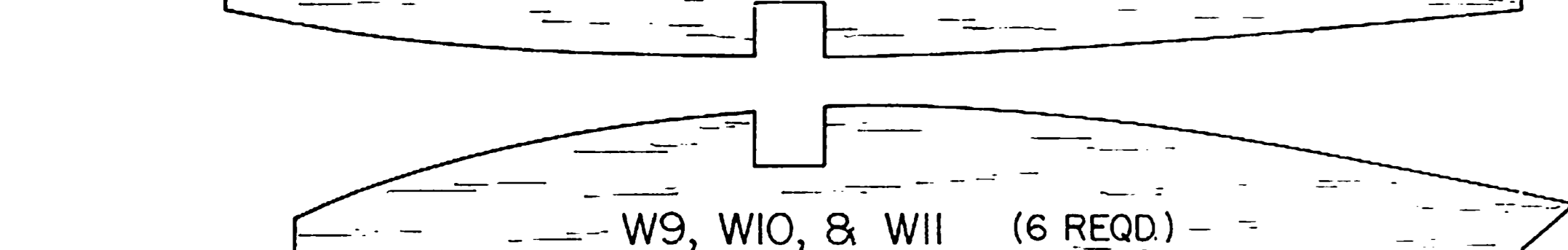

W9, W10, & W11 (6 REQD.)

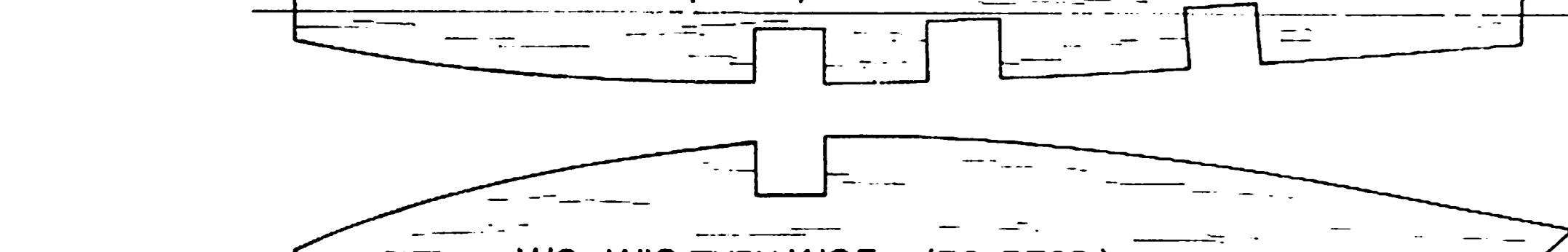

W8, W12 THRU W25 (30 REQD.)

FLAP RIB (28 REQD.)
8 RIBS - 1/16" PLYWOOD, 6 RIBS - 1/8" SHEET BALSAs, 6 RIBS - 3/16" SHEET BALSAs, & 8 RIBS - 3/32" SHEET BALSAs

AILERON RIB (18 REQD.)
6 RIBS - 1/16" PLYWOOD
12 RIBS - 3/32" SHEET BALSAs

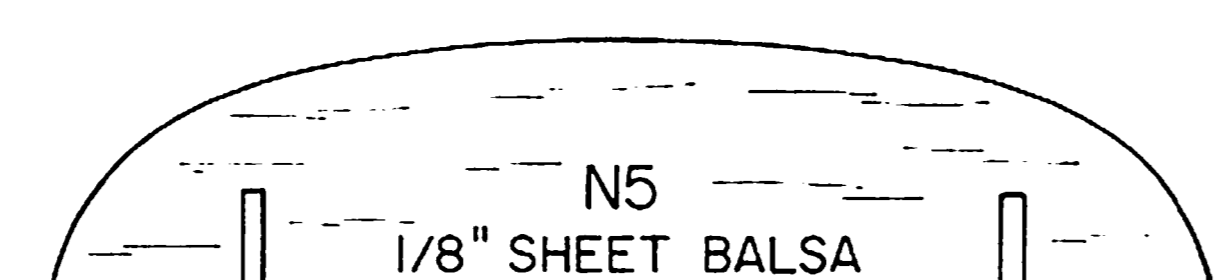

N5
1/8" SHEET BALSAs

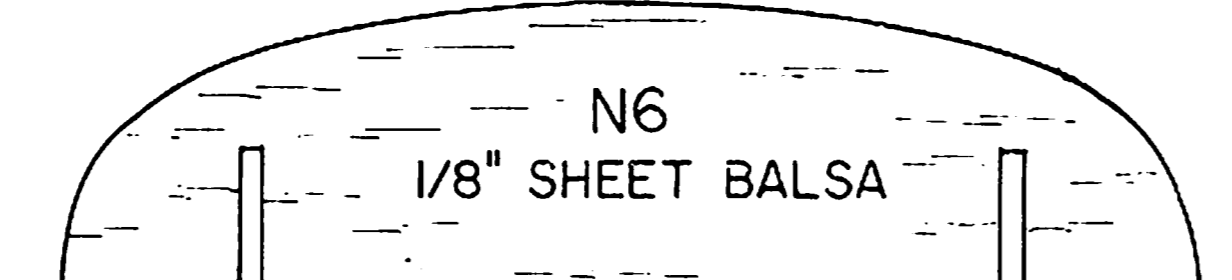

N6
1/8" SHEET BALSAs

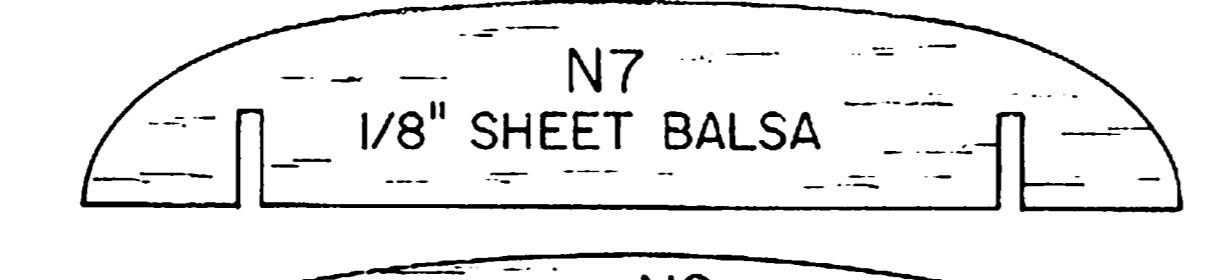

N7
1/8" SHEET BALSAs

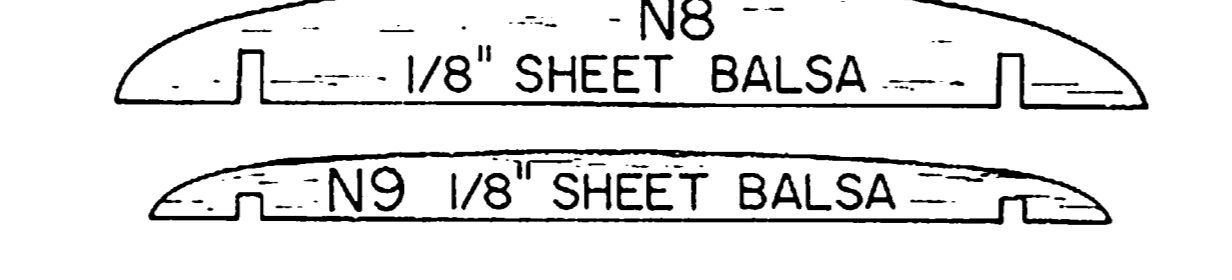

N8
1/8" SHEET BALSAs



N9
1/8" SHEET BALSAs

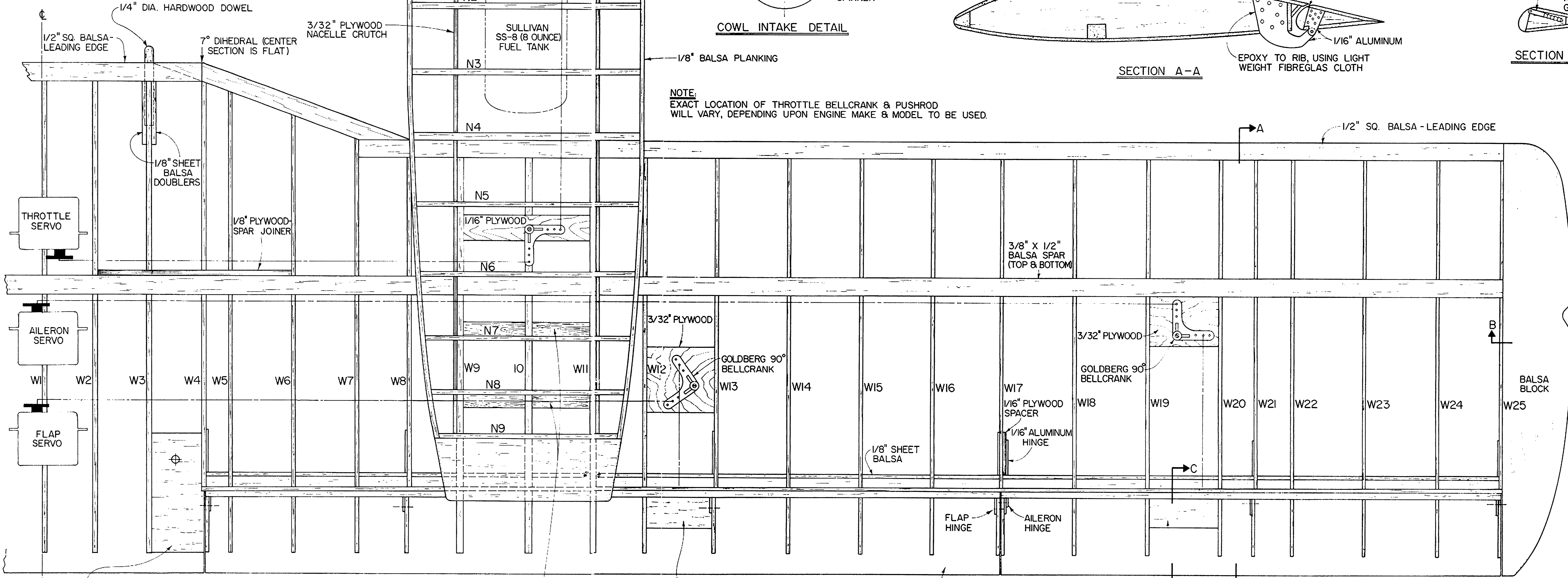

SCALE SPINNER PROFILE-FOR STATIC DISPLAY
FOR FLYING, USE FOX 2 1/2" DIA. "SLIMJIM" SPINNER.

THRUST

K & B 40 R/C ENGINE SHOWN

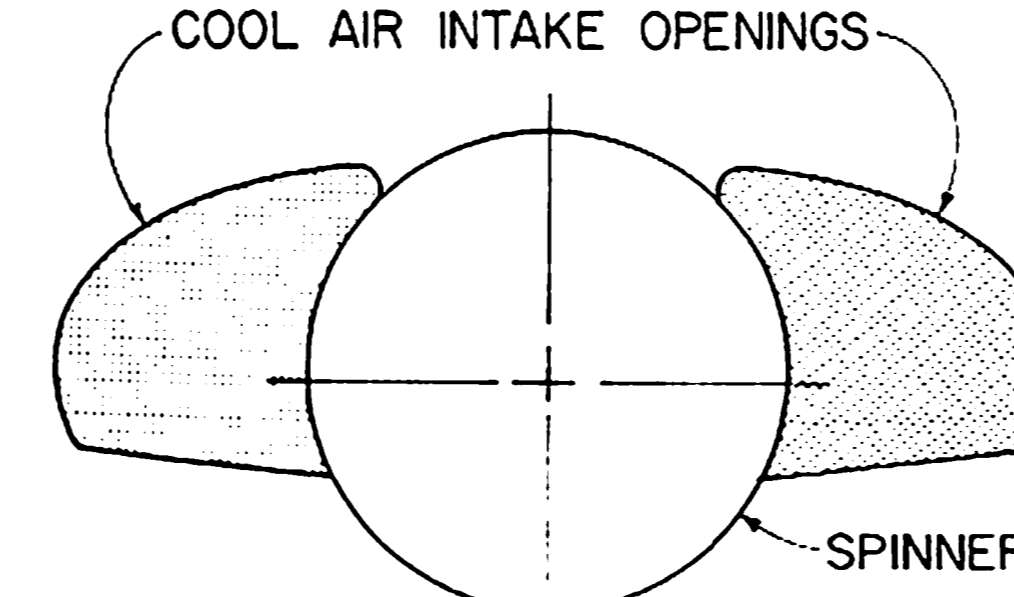

COWL INTAKE DETAIL

NOTE:
EXACT LOCATION OF THROTTLE BELLCRANK & PUSHROD
WILL VARY, DEPENDING UPON ENGINE MAKE & MODEL TO BE USED.

FIBREGLAS COWL OUTLINE

1/2" BALSAs TRIANGULAR STOCK

NOTE: NACELLE LEFT SIDE PLANKING OMITTED FOR CLARITY.

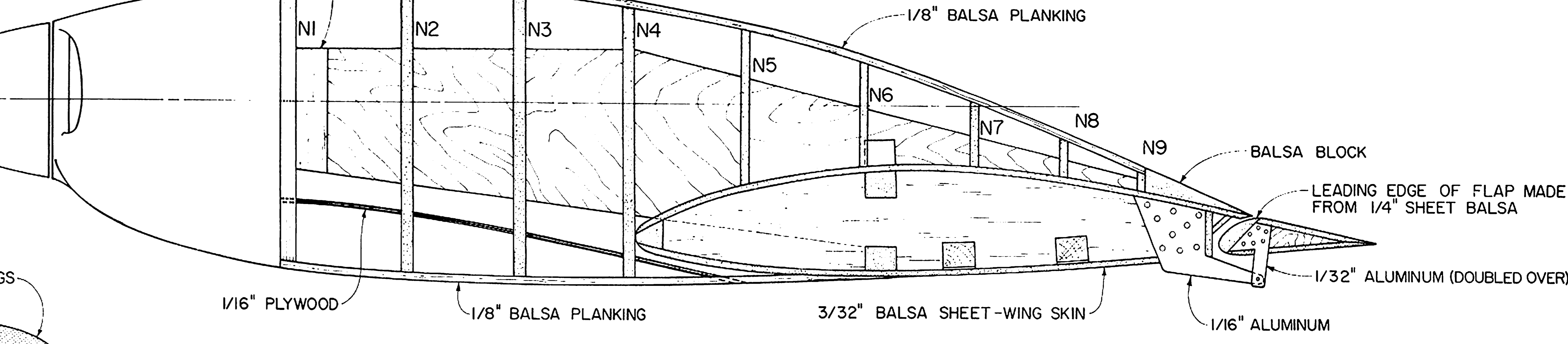

ENGINE NACELLE - SIDE VIEW

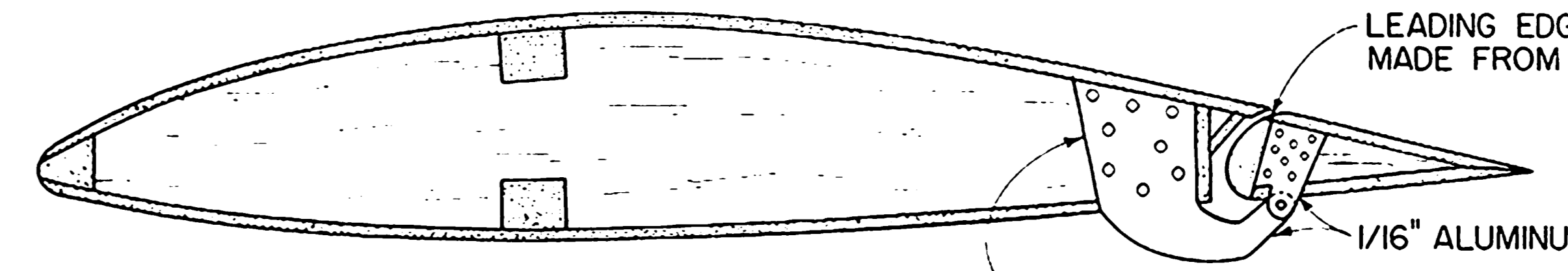

SECTION A-A

TYPICAL INSTALLATION OF ROBERT HORNBY HINGE POINT, IMBEDDED IN BALSAs BLOCK (USED ON AILERONS & FLAPS AS CONTROL HORN). USE SMALL GOLDBERG SNAP LINK ON PUSHROD.

SECTION C-C

WING TIP LIGHT

SECTION B-B

BALSAs BLOCK - FOR WING MOUNTING BOLT

3/8" X 1/2" MAPLE RETRACT LANDING GEAR MOUNTING BLOCKS - SPACING SHOWN IS FOR KRAFT MULTICON RETRACTS

HARD BALSAs BLOCK - FOR MOUNTING FLAP HORN

3/32" BALSAs SHEET - BOTTOM WING SKIN

HARD BALSAs BLOCK - FOR MOUNTING AILERON HORN

NOTE:
WING TOP SHEETING OMITTED FOR CLARITY.

© RCM A.L. COMMERCIAL RIGHTS RESERVED

PIPER SENECA II

A SPORT & AMA SCALE DESIGN

DESIGNED & DRAWN BY JERRY BUGNI

INKED & ARRANGED BY Bob Wallace

By H.E.

SHEET 2 OF 3



SCORE FORMERS F3 THRU F6 TO FACILITATE REMOVAL AFTER ASSEMBLY

DRILL ALL NOSE GEAR HOLES (MOUNTING, STEERING & WIRING) BEFORE ASSEMBLY

1/8" PLYWOOD & 1/8" BALS (LAMINATED)

3/32" PLYWOOD & 1/8" BALS (LAMINATED)

F12
1/4" BALS

NOTE: ALL FUSELAGE FORMERS ARE 1/8" BALS, UNLESS NOTED OTHERWISE.

By H.E
SHEET 3 OF 3

© RCM ALL COMMERCIAL RIGHTS RESERVED

PIPER SENECA II
A SPORT & AMA SCALE DESIGN

DESIGNED & DRAWN BY JERRY BUGNI
INKED & ARRANGED BY Bob Wallace